

# Guide to Reading An Assessor's Plat Map

## **A** Parcel Number

Always in a small circle (occasionally in an oval).

## **B** Book and Page Circle

Indicates what map page (# below the line) adjoins our map and in some cases which Assessor's Book (# above the line).

## **C** Lot Number

Never circled; shows the subdivision lot number of the property.

## **D** "Picture Corner"

Shows the exterior corners of subdivision map boundaries as shown on the map.

## **E** Page Number

Of the Assessor's Book, Page & Picture Corner 1#. This is the full 3-digit number (coinciding with column one in the changes box); always in an oval.

## **F** Acreage Figures

A decimal number with AC following. Not always accurate. Use only as estimate.

## **G** Distances and Bearings

Data on borders of the map. This data is from recorded deeds or surveys.

## **H** Lower Right

Brief legal description of the properties included on this page.

## **I** North Arrow

Will not always be pointing up. SCALE: Is useful if map has been printed to proper size.

## **J** Assessor's Book Number

Followed by first two digits of the Page Number, located in the upper right corner next to arrow.

## **K** Changes Box

Provides the history of the map page.

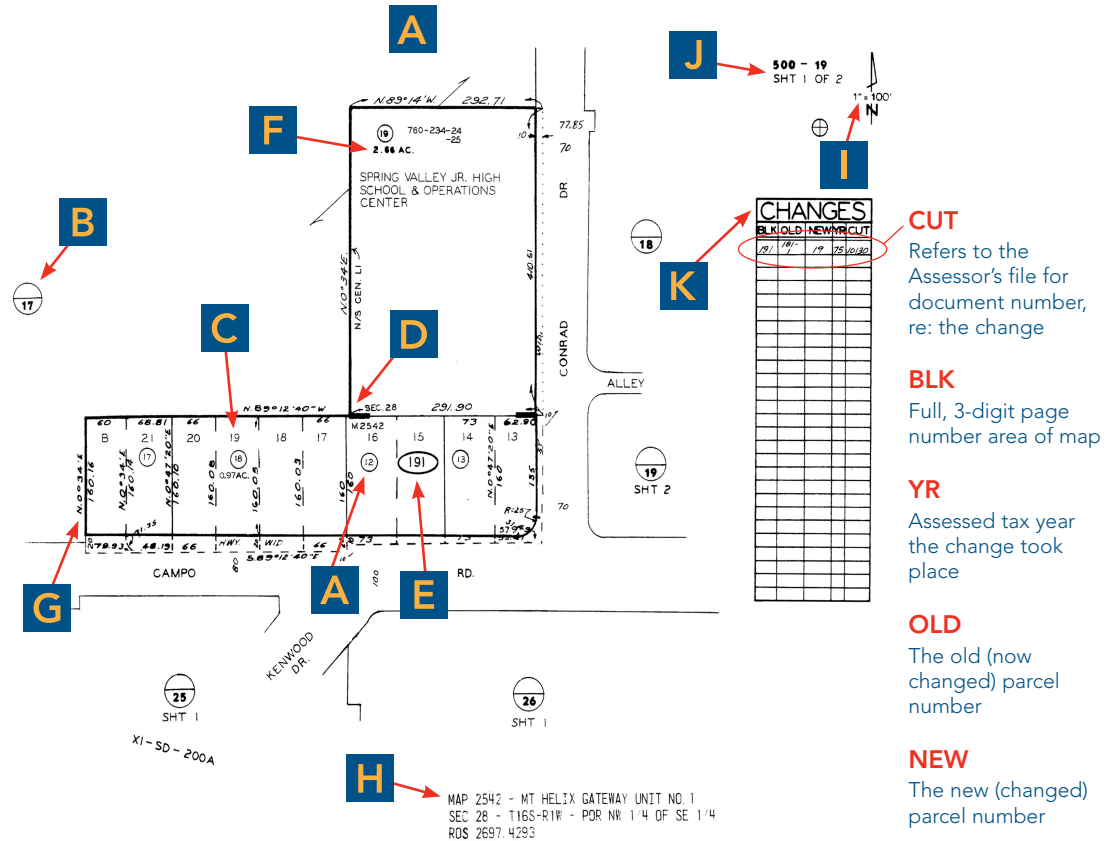

**CUT**  
Refers to the Assessor's file for document number, re: the change

**BLK**  
Full, 3-digit page number area of map

**YR**  
Assessed tax year the change took place

**OLD**  
The old (now changed) parcel number

**NEW**  
The new (changed) parcel number



First American Title™

800.451.0454 | www.firstam.com